

Tamerica EZ-Wire 34 Manual 3:1 Wire Punch and Bind Machine

Instruction Manual



Provided by

MyBinding.com
When Image Matters.

Call Us at 1-800-944-4573

SAFETY REMINDERS & OTHER USEFUL TIPS

1. This machine is not a toy, therefore children should not be allowed to operate it.
2. Make sure your EZ-Wire34 is placed on top of a sturdy surface before use.
3. Keep hair, fingers, jewelry and all loose clothing away from all moving parts of your EZ-Wire34 as they may accidentally be pulled into the machine causing damage to it or worse, injury to the user.
4. Use a test sheet to punch to determine if there will be any holes running off the sides and disengage the appropriate pins.
5. Do not punch more than 20 sheets of 20lb. paper when punching. Preferably, punch no more than 15-18 sheets at a time to help extend the life of your EZ-Wire34.
6. When punching on PVC or PP covers, it is recommended that you punch at a maximum of 2 sheets at a time.
7. Periodically check and empty the waste drawer. An overfilled waste drawer may damage the machine when punching.
8. Protect your EZ-Wire34 keeping it from the elements such as water or excessive heat.
9. Your EZ-Wire34 should not be used other than its intended purpose and function.
10. Always call the authorized dealer first for technical issues or any malfunction. Trying to fix the machine by yourself might not only be dangerous, but may also void the warranty.

WARRANTY INFORMATION

Our machines are guaranteed against defects in materials and workmanship for a period of one year from the date of original purchase from an authorized dealer of TAMERICA PRODUCTS, INC. If you perceive or experience any issue with the machine, kindly report it to the dealer within 10 business days of said purchase to avail of free pickup and redelivery from TAMERICA's Service Center. After the first 10 days, you will either receive service instructions and parts via mail free of charge for the duration of the warranty.

Note that when returning the machine for warranty claims, the machine should be returned in its complete original packaging to avoid incidental or consequential damages that may void the claim. A copy of the invoice or other proof of purchase also needs to be sent with the machine.

Upon evaluation of the machine and the determination of the actual defect, the machine will be restored to its regular working condition by the Service Center and shipped back to you free of charge. If you change your mind and simply want to return the machine, a 20% restocking fee is charged even within the 10-day grace period. Further, you will have to cover freight to return the machine and it has to be in brand-new resalable condition, otherwise, you might incur more charges.

This warranty covers all defects incurred in the normal use of the equipment except in the following cases:

1. Loss or damage to the equipment due to improper operation, abuse, mishandling or failure to follow the operating instructions.
2. Removal or alteration of the serial number.
3. The machine being serviced or modified by anyone other than a certified technician authorized by TAMERICA.

This warranty is valid only within the United States or its provinces and territories.

EZ-Wire34 3:1 Wire Binding Machine



OPERATING MANUAL

IMPORTANT !!!

It will be beneficial to first get yourself acquainted with the features of your EZ-Wire34 before attempting to use. Keep in mind all operational instructions, tips, and safety reminders every time you use your EZ-Wire34 to best achieve desirable results.

FEATURES



SPECIFICATIONS

Binding Material	: Metal Wire
Binding Capacity	: 120 sheets (20lb. Paper)
Punching Capacity	: 20 sheets (20lb. paper)
Punching Length	: 11.7"
Punching Format	: Manual
Hole Distance	: 8.47mm (3:1)
Hole Spec	: 4 x 4mm square
Depth Margin	: 2.5 / 4.5 / 6.5mm
Punch Holes	: 34
Disengageable Pins	: 34
Machine Dimensions	: 17.3"x11"x9"
Machine Weight	: 20.9lbs (9.5kgs)
Warranty	: 1 Year

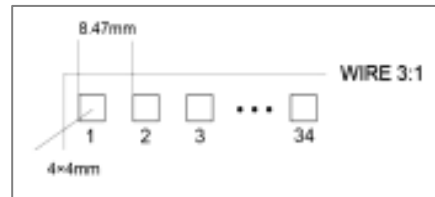

SET-UP

Use this guide to help determine the necessary wire diameter to be used based on sheet capacity.

Wire Size	3/16"	1/4"	5/16"	3/8"	7/16"	1/2"	9/16"	5/8"	3/4"	7/8"	1"
Sheet Capacity	4.5mm	6mm	8.0mm	9mm	10mm	12mm	15mm	16mm	20mm	22mm	25mm
Size	3 : 1						2 : 1				

MACHINE OPERATION



1. Adjust the ruler guide according to the size of your document.



2. Adjust depth margin control from 2.5mm to 6.5mm. This controls how far or how close you want the holes to be in relation to the edge of the document.

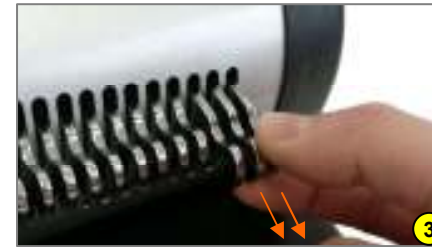

3. Disengage pins that would punch off the edge of the document by pulling them towards you.
TIP: Punch a few test sheets first in order to get the proper alignment.

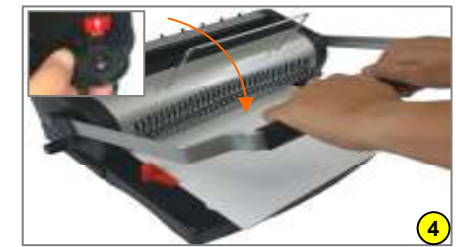

4. Adjust wire closer control to "punch" (see inset) then grasp the punch handle with 1 or 2 hands and pull down to punch holes on the document.



5. Position the wire on the wire holder. TIP: Flip the back cover over to make it face the front (see inset) then insert into the wire making sure all teeth go through the holes.



6. Adjust wire closer control to the appropriate size (see inset "a"). Insert the document into the wire closer with the wire facing downward (see inset "b") then pull the handle down to close. Remove the bound document and flip over the back cover to complete the binding process.



TIP: Periodically empty the waste bin to help ensure uninterrupted use.

Please turn to next page for safety reminders and other useful tips on the proper operation of your EZ-Wire34.